

12AL150 12ALZ150

AMARON QUANTA™

The industrial segment SMF-VRLA (Valve Regulated Lead Acid) battery for UPS applications is built to perform.

In short, the lifeline to your UPS applications

AMARON QUANTA™ is a product of fail- safe, fool-proof battery technology, produced and tested in our premier manufacturing facility. Built to the highest technical competence in its class, the QUANTA is an example of Amara Raja's commitment to bringing the best of technology to your table

It features several firsts for the battery industry like the unique Radgrid™

TERMINAL LAYOUT

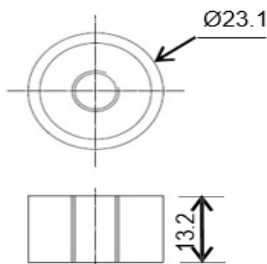

All dimensions are in mm

Specification

Nominal Voltage	12V
Rated Capacity	150Ah / C ₂₀ Hr / 1.75VPC / 27°C
Dimensions (±2mm)	Length 453 mm (17.83 in.)
	Width 173 mm (6.81 in.)
	Total Height 251 mm (9.88 in.)
Weight (±5%)	45.0 Kg (99.21 lbs)
Terminal Type	M8 x 25mm Copper terminal
Capacity @ 27°C	139.70 Ah (10hr, 13.97 A, 10.5 V/battery)
	128.65 Ah (5hr, 25.73 A, 10.2 V/battery)
	95.54 Ah (1hr, 95.54 A, 9.6V /battery)
Capacity affected (Temperature at C20 hr rate)	40°C (104°F) 110%
	27°C (80.6°F) 100%
	0°C (32°F) 80%
	-15°C (5°F) 60%
Case Material	Standard PPCP (12AL150)
	FR Version UL 94-V0 (12ALZ150)
Internal Resistance (IR)	Approx. 4.86 mΩ for a fully charged battery (27°C)
Short Circuit Current (As per IEC)	2633 A
Operating Temp. range	-20°C to +60°C (50 to 60°C for shorter duration)
Nominal Operating Temp. range	27°C ± 3°C
Standby use (27°C)	Charging Voltage 13.5 V/battery
	Charging Current Max. 25% of rated capacity
	Temp. Compensation ± 18mV/battery/°C
Cyclic use (27°C)	Charging Voltage 13.8 V/battery
	Charging Current Max. 25% of rated capacity
	Temp. Compensation ± 30mV/battery/°C
Self-Discharge	< 4% per month at 27°C

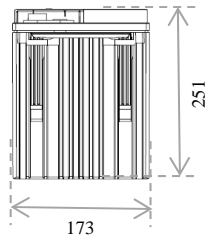
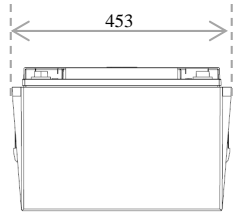
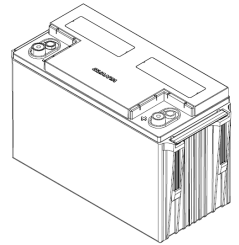

Constant Power Discharge Rating (Watts Per Battery) @ 27°C *

ECV/ Time	10min	15min	20min	30min	60min	2hrs	3hrs	5hrs	8hrs	10hrs	20hrs
1.60	3594	2801	2269	1817	1125	680	495.0	340.0	225.0	183.0	93.0
1.65	3441	2764	2223	1786	1100	670	483.5	325.5	219.0	181.5	92.5
1.70	3288	2727	2177	1755	1075	659	470.0	318.0	213.0	180.0	92.0
1.75	3135	2690	2127	1724	1050	649	456.0	310.0	210.0	178.5	91.0
1.80	2982	2570	2078	1693	1024	638	442.0	302.0	207.0	177.0	90.0

Constant Current Discharge Rating (Amperes) @ 27°C *

ECV/ Time	10min	15min	20 min	30min	60 min	2 hrs	3 hrs	5 hrs	8hrs	10 hrs	20 hrs
1.60	326.09	258.62	211.26	153.06	95.54	59.08	40.38	27.79	17.24	14.59	8.03
1.65	316.11	250.28	204.31	150.79	94.65	56.69	39.16	26.76	16.87	14.41	7.83
1.70	306.12	241.94	197.36	148.51	93.75	54.29	37.94	25.73	16.49	14.23	7.63
1.75	300.00	238.10	194.80	147.06	91.46	53.57	37.88	25.64	16.39	13.97	7.50
1.80	294.12	230.77	189.80	144.23	89.29	53.19	37.69	25.42	16.30	13.89	7.46

Note:

- The above data are average values per battery and can be obtained within five charge/discharge cycle
- A tolerance of ±5% is applicable for the above constant power discharge and constant current discharge values.
- Recommended to follow IEEE -485 Standard for Battery sizing (In terms of Aging Margin, Design Margin) for Optimal Performance & Life.
- Considerable Voltage drop across cables, if any shall be considering during battery sizing.



AMARA RAJA
Gotta be a better way

**Design improvement is a continuous process of Amara Raja. As a result, specifications are subject to change without prior notice



CAUTION

- ⚠ Avoid short circuit
- ⚠ Don't charge in a sealed container



THE LONG LIFE UPS BATTERY



Performance

A clutch of design features ensures that AMARON QUANTA™ batteries perform predictably and reliably every time

- ✓ Proven AGM technology that ensures maintenance free characteristics
- ✓ A unique heavy duty corrosion-resistant alloy for positive grids to increase cyclic life in tropical
- ✓ Radgrid™ profile provides lower internal resistance and superior high-discharge performance
- ✓ Instacharge™ a patented paste recipe for excellent charge acceptance
- ✓ Low self-discharge rates for extended storage periods
- ✓ Design Float life of upto 10 years
- ✓ Clean and Sleek looks

Discharge Characteristics

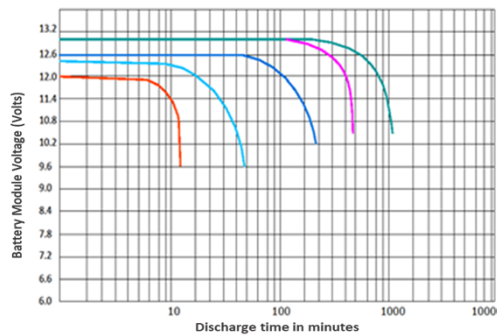

Shelf Life Characteristics

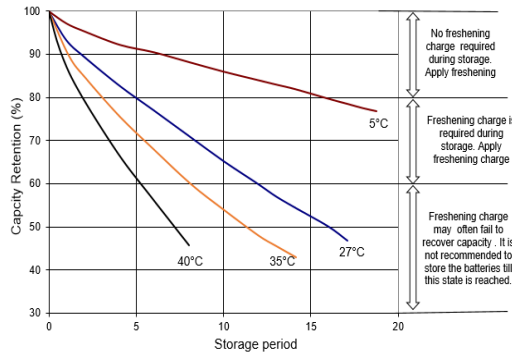

Compliance

- ✓ JIS C 8702 Certified
- ✓ UL (UL-1989) & CE Certified
- ✓ Complies to IEC61056 & EUROBAT
- ✓ Complies to IS 16220
- ✓ Manufactured in ISO 9001, ISO 14001, ISO45001:2018 certified facilities

Applications

- ✓ Data Centers
- ✓ Banks & Financial Markets
- ✓ Network Operations Centers
- ✓ Industrial Process Control Facilities
- ✓ Safety, Surveillance & Security Systems
- ✓ Semiconductor Manufacturing
- ✓ Power Generation Plants
- ✓ Hospital & Testing laboratories

Temperature Effect on Capacity

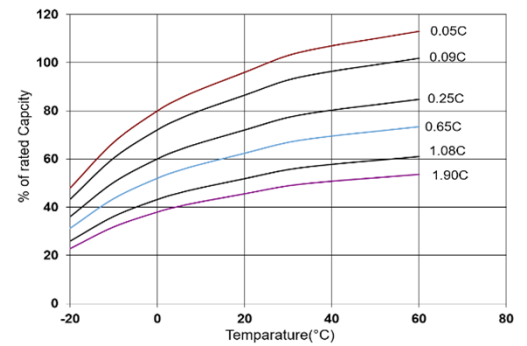

Float Service Life vs. Temperature

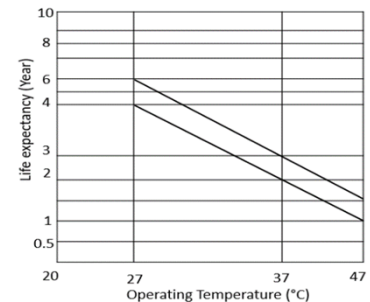

AMARA RAJA ENERGY & MOBILITY LIMITED

(Formerly Known as Amara Raja Batteries Limited)

CORPORATE OPERATIONS OFFICE:

Terminal A, 1-18/1/AMR/NR, Nanakramguda, Gachibowli, Hyderabad-500032, India. [E-Mail: mktg@amararaja.com](mailto:mktg@amararaja.com)
www.amararajaandm.com

REGISTERED OFFICE & Manufacturing Facility-1:

UNIT-I, Karakambadi - 517520, Tirupati, Andhra Pradesh, India, TEL: +91-877-2265000, FAX: +91-877-2285600

Manufacturing Facility-2

UNIT-II, Nune Gundlapalle, Bangarupallyam, Chittoor - 517416, Andhra Pradesh, India



AMARA RAJA
Gotta be a better way

ARE&M/IAE/AQ/150Ah; Oct'2023, Rev-01